

FURNITURE FITTINGS

— PERFECTED FOR EVERY FIT —



CONNECTOR
TECHNOLOGY
& SHELF SUPPORT

PAGE
1.1 - 1.16



HINGES &
FLAP
FITTINGS

PAGE
2.1 - 2.38



LOCKS
&
CATCHES

PAGE
3.1 - 3.18



DRAWER
RUNNER
SYSTEM

PAGE
4.1 - 4.13

**Dear Valued Customer and Business Partner,**

What you have in your hands is our latest edition of "Furniture Fittings Catalogue 2025". If you are seeking for a tested quality product, we trust that this catalogue will become your first point of reference in your furniture hardware selection. We have carefully selected the most complete hardware collection for your production to offer you new ideas and solutions that increase functionality but still offer a nice design and proven quality. Not to worry if you need something that is not in these pages or you are seeking for any special application or certificate, we are always there for you with the most comprehensive offering in our international catalogues that our sales representatives or expert advisers can identify and order for you. Thank you very much for your continuing support and trusting Häfele as your partner.

Best regards,
David Lorenzo Ramos
Managing Director

HÄFELE FUNCTIONALITY: THE WORLD'S BIGGEST SELECTION OF PROBLEM SOLVERS

We have committed ourselves to finding solutions to tomorrow's problems today. And it doesn't stop with innovative fittings – it also encompasses the development of new or improved processes and systems. For example, the option of supplying bespoke, fully assembled drawers which you can then offer your customers at an attractive price, even in quantities starting at one. We also develop all of the aids which simplify the use of the products for you. From drawings to drilling templates and product training. Always focusing on optimising your work processes in the best possible way.

HÄFELE WORLDWIDE

Häfele's Headquarter is located in Nagold, Black Forest, German with a 100% private ownership. Häfele is the leading company in the distribution field of furniture fittings and architectural hardware. The Häfele Group international sales centres are characterized by a unique product range concept in the furniture fitting and architectural hardware sector, as well as individual consultancy and comprehensive logistic systems. Häfele employs a workforce of around 4,700 people worldwide working in 37 countries on 5 continents.

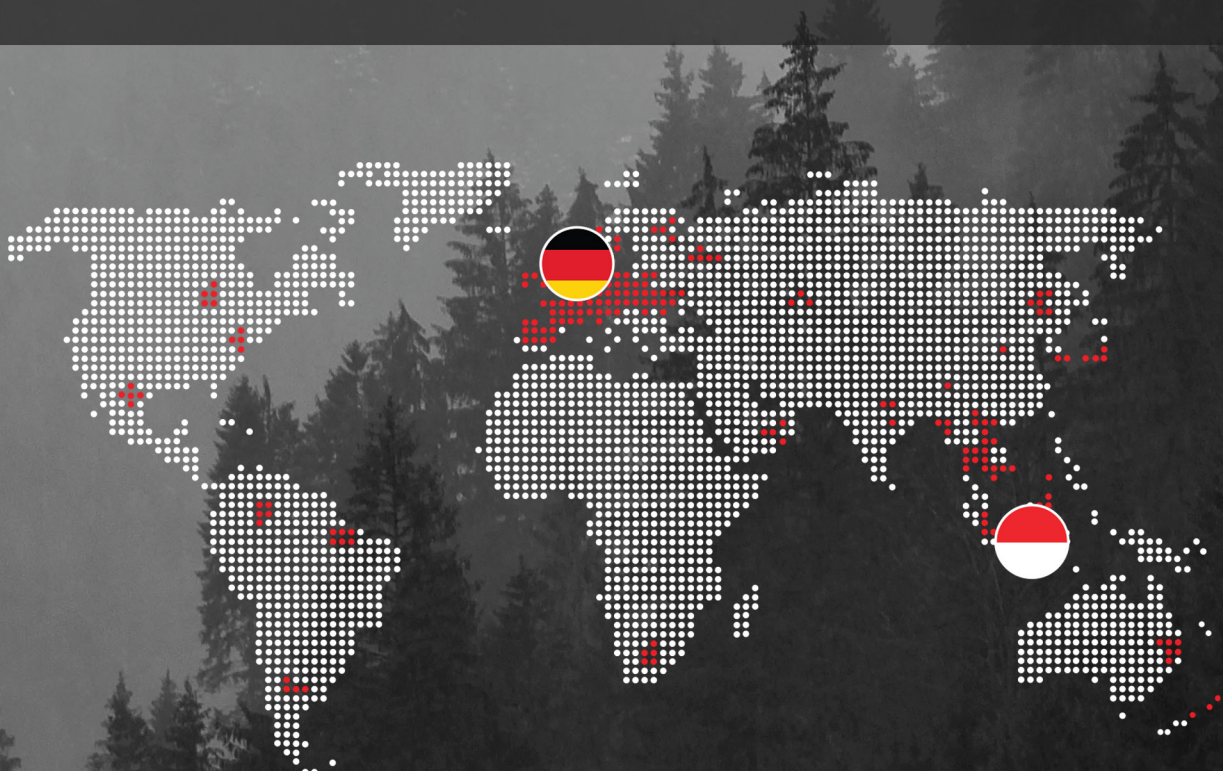



At Häfele, we recognise the importance of quality, function and design when it comes to making furniture.

That's why we have launched the Häfele Lifetime Guarantee across all of the products that we manufacture or bring to you under the Häfele brand name.

All products that carry a Häfele Lifetime Guarantee have met our quality standards and have been tested according to the relevant industry certification, to the point that we are now happy to guarantee that the product will function as intended with no loss of operating quality, for the guaranteed lifetime period of that product.

We are confident in our **range of products**, and we want you to be as confident when you use our products for your customer as we are.

HUBUNGI:



QHOMEMART

**JL.RAYA JANTI NO.96 YOGYAKARTA
(0274) 493 22 88 , 08112863773 (CHAT ONLY)**

f qhomemart t qhomemart @ qhomemart y qhomemart

WWW.QHOMEMART.COM

1

CONNECTOR TECHNOLOGY & SHELF SUPPORT



1

Häfele Minifix Connector Housing

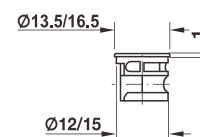
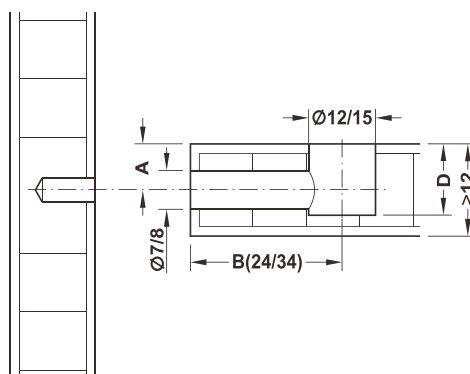
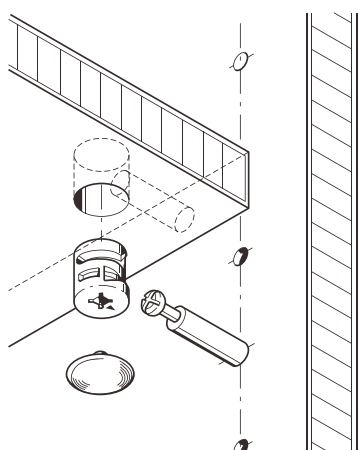

With rim

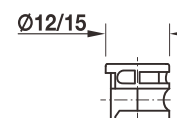

Without rim

- > Material: Zinc alloy
- > For housing: 12 or 15 mm
- > Bolt hole: Ø 7 or 8 mm, depending on choice of connecting bolt
- > Drilling distance B: Distance from centre of Minifix housing to shelf front edge (24 or 34 mm), depending on choice of connecting bolt
- > For all connecting bolts from the Minifix system

Häfele Minifix 15 Without Rim

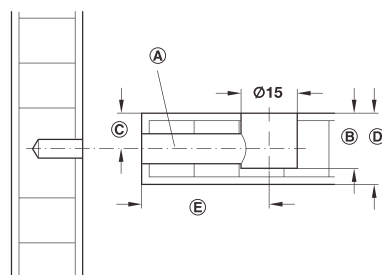
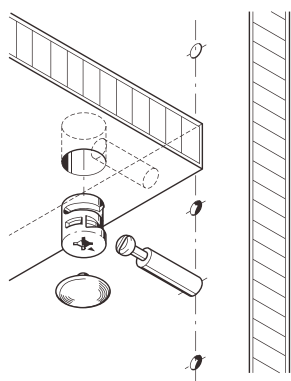

- (A) Bolt hole
- (B) Drilling depth
- (C) Dimension A
- (D) Wood thickness
- (E) Drilling distance B

For wood thickness mm	Drilling depth D mm	Dim. A mm	Packing pieces	Bright	Nickel Plated
From 12	9.5 ^{+0.2}	6	100 or 1000	262.26.070	-
From 15	12 ^{+0.5}	7.5	100 or 2000	-	262.26.532
From 18	13.5 ^{+0.5}	9		-	262.26.534

Connecting Bolt

S200 Connecting Bolt

For drilled hole Ø5 mm and bolt head

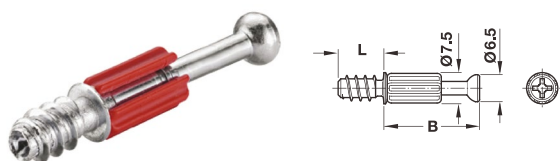

- > Material: Steel,
- > Shank: Plastic
- > Thread: Special thread
- > Drive: PZ2 cross slot

Thread length L mm	Drilling distance B mm	Finish	Art. No.
11	24	Galvanized	262.27.679

Packing: 100 or 2,000 pcs

1

M6 Spreading and Glue-in Sleeves

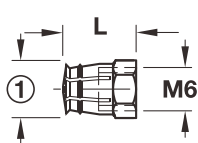

① for drill hole diameter
spreading sleeve

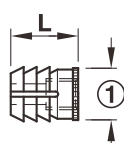

① for drill hole diameter
Glue-in sleeve

Drilling distance B mm	Length L mm	Finish	Art. No.
8	11	Polyamide	039.33.462
10	11		039.33.266
	13		039.33.060

Packing: 100, 1,000 or 5,000 pcs

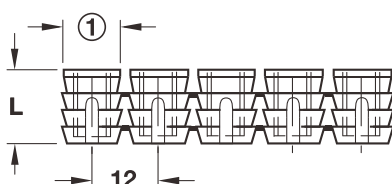

① for drill hole diameter
Strip of glue-in sleeves

S100 Connecting Bolt

For drilled hole Ø5 mm and bolt head



- > Thread: Special thread
- > Material: Steel yellow galvanized
- > Drive: PZ2 cross slot

Finish	Thread length L mm	Drilling distance B mm	Art. No.
Galvanized	8.5	24	262.27.615

Packing: 100 pcs



Häfele Rafix 20 cabinet connectors

The Rafix 20 cabinet connector systems have zinc alloy tightening elements that are based on the centric principle.

The advantages are:

- Secure tightening, even after repeated slackening and re-tightening
- No offsetting against the side panels, because the bolts are centrally guided
- Tolerances are compensated for by long tightening distance
- Comfortable tightening with drive tool in 25° position
- All drilling operations take place on a flat surface

Rafix 20		<ul style="list-style-type: none"> > Connector housing made from zinc alloy or plastic > Connector housing without dowel > With tightening element for tightening and fixing of the components > Only one drill hole > With or without rim (zinc alloy housing available only with rim) > Connector housing made from zinc alloy or plastic > Connector housing with dowel > With tightening element for tightening and fixing of the components > Can be used for alignment, the dowel provides accurate positioning > Better pull out resistance values > Valuable, robust appearance
----------	---	---

Installation

The Rafix 20 connector housings have two types of recess to accommodate a connecting bolt:

① Without ridge:

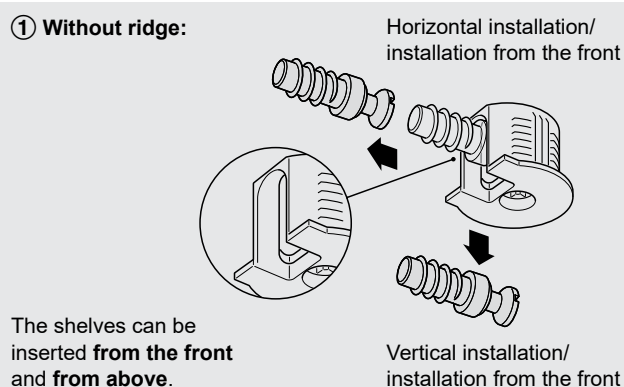

② With ridge:

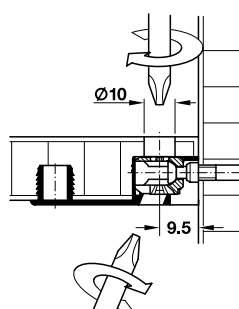
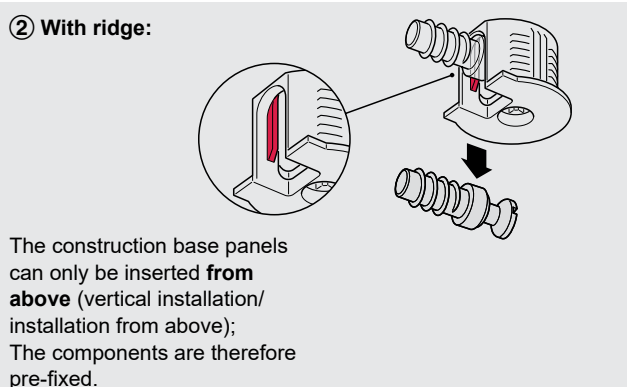

Access from above to the tightening element is possible due to the specially designed housing. Concealed installation of the connectors is therefore possible (e.g. with shelves) and tightening via a Ø 10 mm through hole. The through hole is then concealed using a cover cap. Comfortable tightening of the connector from underneath with screwdriver in **25° position**.

Häfele RAFIX 20 connector housing without dowel

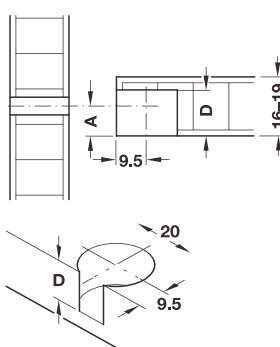
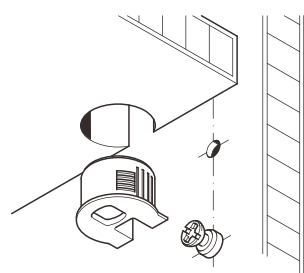

With or without ridge

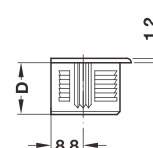

Rafix**Rafix 20 Without Dowel**
Zinc Alloy, with Tightening Element

- > Material: Zinc alloy, zinc alloy tightening element
- > Drive: Pz2 cross slot

For wood thickness mm	Drilling depth D mm	Dim. A mm	Finish	Art. No.
19	14.2 ^{+0.2}	9.5	Nickel Plated	263.11.705

Packing: 100 or 500 pcs

Rafix S20 Connecting Bolts

For drill hole Ø3 mm

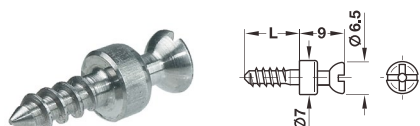

- > Material: Steel
- > Thread: Special thread
- > Drive: PZ2 cross slot and flat blade

Thread length L mm	Finish	Art. No.
11	Galvanized	263.20.810

Packing: 100 or 2,000 pcs

For drill hole Ø5 mm

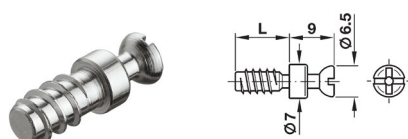

Thread length L mm	Finish	Art. No.
11	Galvanized	263.20.847

Packing: 100 or 1,000 pcs

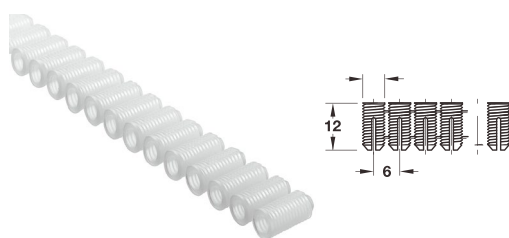
Glue-in dowel magazine
For drilled hole Ø5 mm

For drilling hole mm	Material	Art. No.
Ø5	Nylon	042.98.0515

Packing: 1,000 pcs

Maxifix 35 Carcase Connectors

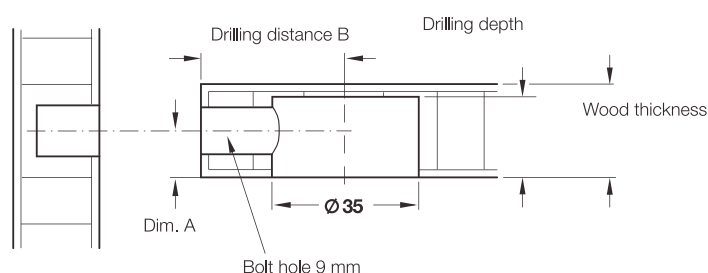

The MAXIFIX 35 carcase connector is particularly suitable for connections that are permanently subjected to high loads such as connections in carcases and beds, counters and face-frame furniture. Can be used for wood thicknesses of 19 mm and above. The MAXIFIX 35 carcase connector is particularly suitable for mass manufacture in the furniture industry.

MAXIFIX 35 Connector housing



With cross slot

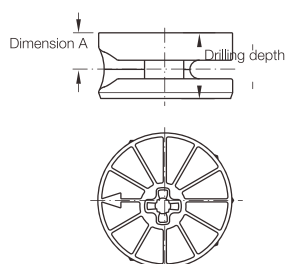

- > Dimension A: 9.5 mm
- > Drilling depth: 15.5 mm
- > Material: Zinc alloy

For wood thickness mm	Finish	Art. No.
PZ3 cross slot		
Min. 19	Bright	262.87.013

Packing: 10 or 250 pcs

MAXIFIX S35 Connecting bolt

With M8 thread for MAXIFIX 35

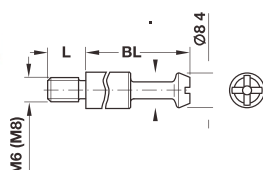
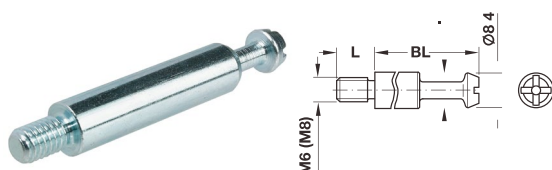

- > Material: Steel
- > Thread length L: 9.5 mm
- > Drive: PZ2 Cross Slot
- > Bolt hole: 9 mm

Thread	Finish	Drilling depth B mm	Bolt length BL mm	Art. No.
M8	Galvanized	55	48.5	262.87.912

Packing: 10 or 100 pcs

Screw-in dowel

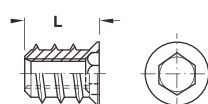

- > Material: Steel
- > Thread length L: 9.5 mm

Inside Thread	For drill hole mm	Length L mm	Finish	Art. No.
M8	Ø10	17	Yellow Chromatized	030.10.585

Packing: 100, or 2,000 pcs

Wood Biscuits, Wood Dowels & Screws

Wood Biscuits, Thickness 4mm



Size	G.depth mm	Length L mm	Width B mm	Material Beech	Material Birch
0	8	47	15	267.90.000	-
10	10	52	53	267.90.010	267.87.890
20	12	56	23	267.90.020	267.87.891

Packing: 100 or 1,000 pcs

Wood Dowels



> Material: Beech / Birch
> Suitable for automatic feed

Diameter mm	Length L mm	Contents pcs/kg	Material Beech	Material Birch
6	25	Approx. 2,150	267.82.125	267.87.800
8	25	Approx. 2,150	267.82.225	267.87.811
	30	Approx. 1,000	267.82.230	267.87.812
	40	Approx. 760	267.82.240	267.87.816

Packing: 10kg

PZ Countersunk head

Fully threaded, galvanized

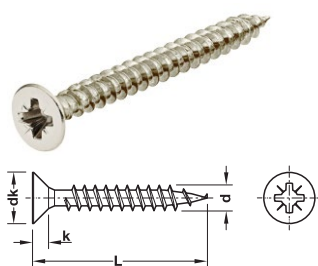

Thread Ø d mm	Head Ø dk mm	Head height k	Drive
3.0	5.0/6.0	1.8	PZ1
3.5	7.0	2.1	PZ2
4.0	8.0	2.4	PZ2
4.5	9.0	2.7	PZ2
5.0	10.0	2.9	PZ2

Thread Ø D mm	Length L mm	Packing pieces	Art. No.
Orga Box			
3.0 (Head Ø 6.0)	15	1000	015.31.531
	20	1000	015.31.559
3.5	15	1000	015.31.639
	20	1000	015.31.657
4.0	15	1000	015.31.826
	20	1000	015.31.844
	25	1000	015.31.853
	30	1000	015.31.862
	35	500	015.31.871
	40	500	015.31.880
	45	500	015.31.899
	50	500	015.31.906

Fully threaded, nickel plated

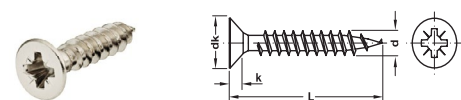

Thread Ø d mm	Head Ø dk mm	Head height k	Drive
4.0	8.0	2.4	PZ22

Thread Ø D mm	Length L mm	Packing pieces	Art. No.
Orga Box			
4.0	15	1000	015.35.824
	17	1000	015.35.833

Chipboard screws - Hospa

PZ Countersunk head, fully threaded, with central hole

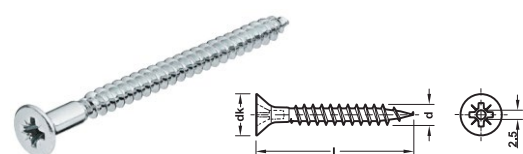

Thread Ø d mm	Head Ø dk mm	Drive
4.5	9.0	Pz2
5.0	10.0	PZ2

> Material: Steel, Galvanized
> Drive: PZ Cross slot
> With central hole 2.5mm for secure grip of cover caps

Thread Ø D mm	Packing pieces	Art. No.
Orga Box		
4.5 x 25	1000	015.01.935
4.5 x 30	1000	015.01.944
4.5 x 35	500	015.01.953
4.5 x 40	500	015.01.962
4.5 x 50	200	015.01.980

Modular Connection

Modular Connection Fitting for Recess Mounting

Installation

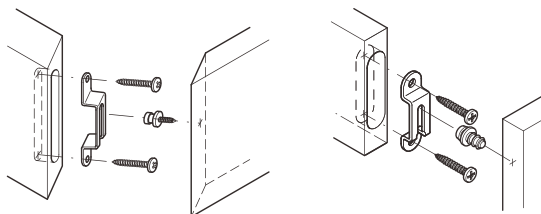

The plate should always be installed so that the supporting plate butts against the end of the recess.

For rapid release fastenings

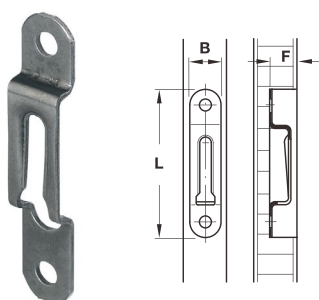

- > Material: Steel
- > Finish: Burnished
- > Installation: For recess mounting

Min. wood thickness mm	Length L mm	Width B mm	Milling depth mm	Art. No.
17	58	13	11.3±0.05	262.47.021

Packing: 100 or 1,000 pcs

Modular Connecting screw

For one-sided installation in wood

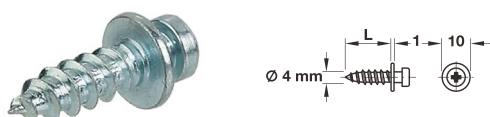

- > Material: Steel
- > Finish: Galvanized

For modular plate width mm	For drilled hole mm	Thread length L mm	Art. No.
11-13	Ø4	16	262.47.987

Packing: 100 or 500 pcs

Bed Fitting



Bed Fitting with Cranked Hook-in Part

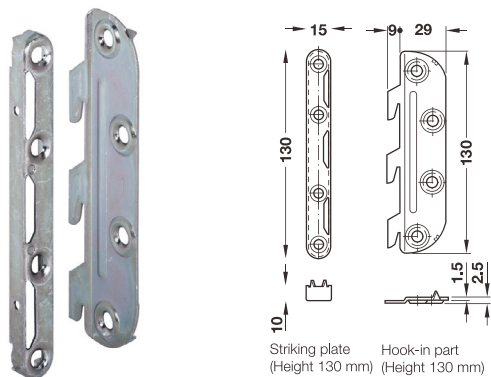

- > Material: Steel
- > Mounting: Left and right hand
- > Installation: For screw fixing

Supplied with (per unit)
4 Striking plates
4 Hook-in parts

Height mm	Finish	Art. No.
130	Blue galvanized	271.03.531

Packing: 10 or 30 pcs

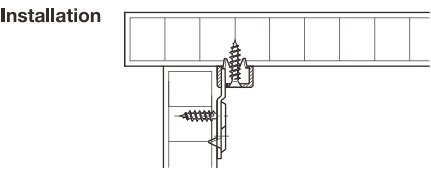

Bed Fitting for beds with central tie bar
Disengageable

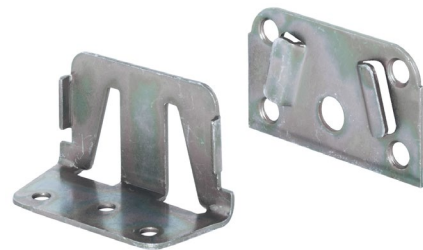

- > Material: Steel
- > Installation: For screw fixing

Supplied with
1 Supporting bracket
1 Retaining plate

Finish	Art. No.
Blue galvanized	273.03.515

Packing: 1 pc

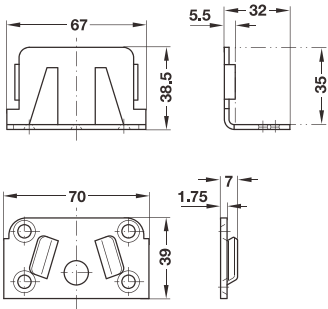

Shelf Support and Retainer

Plug-in Shelf Supports

Plug in adjustable shelf supports are used extensively in kitchen cabinetry and wardrobe units. They are easily adjusted and offer a discreet shelving solution with easy height adjustment.

1

Shelf supports for wooden shelves for plug fitting

in drill hole Ø7 mm or 7.5 mm (with sleeve)



Shelf support

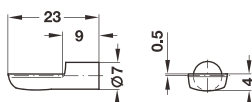

- > Material: Steel
- > Installation: For plug fitting into drill hole Ø 7 mm

Finish	Art. No.
Nickel plated	282.01.701

Packing: 100 or 1,000 pcs

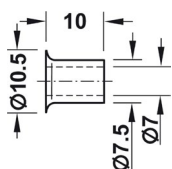

- > Area of Application: For mounting shelf support in 7.5mm drill holes
- > Material: Steel
- > Installation: For plug fitting into drill hole Ø 7.5 mm

Finish	Art. No.
Nickel plated	282.50.704

Packing: 100 or 1,000 pcs

Shelf Retainers for Wooden Shelves, for Plug Fitting

into drill hole Ø5 mm

Shelf retainer, plug-in, for Ø 5 mm hole

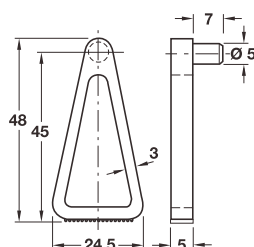

- > For Ø 5 mm series-drilled holes at 32 mm intervals
- > For 19 mm shelf thickness
- > Plastic
- > Order qty: Multiples of 100 pcs

Colour	Art. No.
Beige	282.28.739

Packing: 100 or 500 pcs

Tests are needed at the highest level so that we can guarantee quality over the long term.

Our shelf supports have been tested in accordance with and fulfill the new European standards DIN 68874-1 and DIN EN 16337



Bauart geprüft
Sicherheit
Regelmäßige
Produktions-
überwachung

www.tuv.com
ID 2000000000

Lamello Clamex P-14/10 Cabinet connector

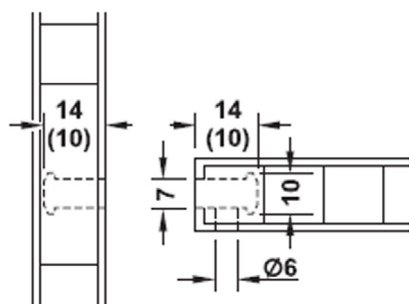
**Clamex P-14 (P-10)**

P-System



Note

- > The Bisco P straightening biscuit is the ideal addition to the Clamex P-14/10 for P system grooves
- > The Lamello Zeta P2 biscuit jointer and biscuit jointer with profile groove function are required for installation
- > The profile groove can be milled with the biscuit jointer with profile groove function using a CNC machine for series manufacture



- > Quick and toolless installation
- > Positive-fit anchoring – no glueing, no screwing
- > Can be removed and re-tightened often, suitable for continuous use, e.g. for trade fair construction
- > Powerful connections, since the tensioning element makes high force transfer possible
- > Lateral adjustment possible

> Area of application: For corner, center panel and surface connections, and mitre connections from 30°-180°, for solid wood and board material

Installation

1. Mill 7 mm groove with T-slot for connector
2. Drill 6 mm opening for tightening element
3. Slide in connector
4. Join workpieces and tighten with SW4 Allen key

Clamex P-14/10 Connector

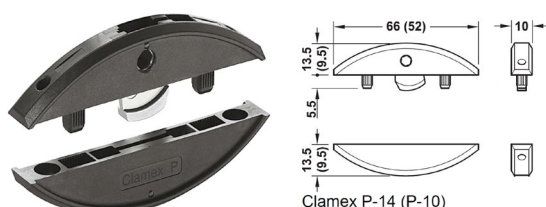
**Clamex P-14 (P-10)**

- > Material: Plastic, bolt: Zinc alloy
- > Drive: SW 4 Hexagon socket
- > Adjustment facility: Lengthways ±1.5mm

	For wood thickness mm	Art. No.
Clamex P-14	From 16	267.91.166
Clamex P-10	From 13	267.91.165

Packing: 1,000 pcs



Lamello Tenso P-14 Biscuit Connector

With pre-stressing facility

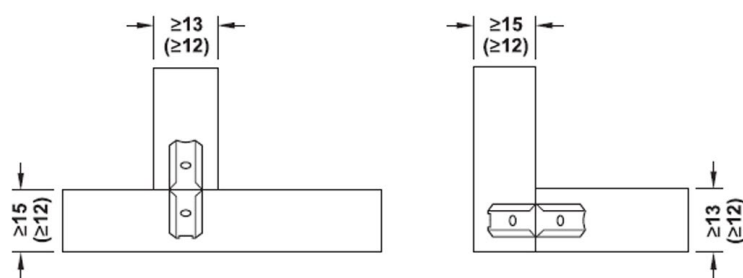

Tenso P-14 (P-10)

P-System



Note

- The connector must always be used in combination with glue.
- The connection cannot be separated after engagement of the Tenso P-14 when glue applied.
- Trial connection with Bisco P-14 possible.
- Lengthways groove and system groove required: Processing with Lamello Zeta P2 biscuit jointer or CNC machine



The ideal glueing aid:

- > Without using clamps or pressing devices
 - > Completely concealed/invisible
 - > Facilitated storage and transport of the work pieces
- New pre-load clip features:
- > Little effort: Only briefly applying pressure is needed for engaging the fitting
 - > Easy connection of workpieces, even with several connectors
 - > The pre-load clip is easily pushed in using the installation tool

- > Area of application: Gluing aid for cabinets with centre panels and intermediate shelves, or column claddings in stores, for drawers, installation of front panels, plug fitting onto plinths, ceiling panels, covers and handle profiles
- > Material: Plastic
- > Routing depth: 14 mm
- > Tolerance: Specification: Lateral: ± 1 mm, sliding tolerance: ± 2 mm
- > Tensile force: approx. 15 kg/connector,
- > Retention force: approx. 25 kg/connector

Lamello Tenso P-14 Connector Component

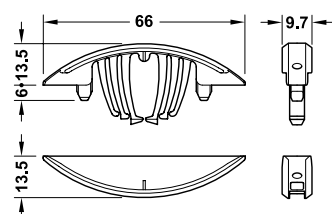

Art. No.

Connector component Lamello Tenso P-14

267.91.153

Packing: 1,000 pcs

Order reference

1 piece = 1 pair

Note

Optimised product, also for use with pre-load clip.



Lamello Divario P-18 Sliding Connector

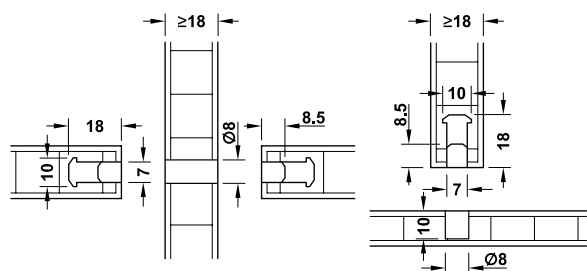

- > Can be pushed in effortlessly until tightening point is reached
- > Shelves can be removed and re-tightened repeatedly, e.g. for transport
- > Quick and tool-less installation without glue or clamping aids
- > Concealed connection with evenly closed gaps

- > Self-clamping, invisible fitting for slide insertion
- > Material: Plastic, fiberglass reinforced

P-System



Note

Lengthwise and system grooves required. The Lamello Zeta P-2 biscuit joiner and HM biscuit joiner are required for installation. The profile groove can be milled with the HM biscuit joiner with a CNC machine for series manufacturing.

Lamello Divario P-18

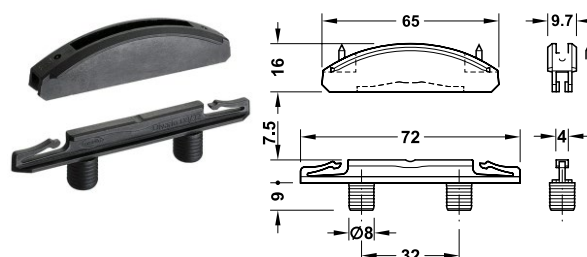

Lamello Divario P-18 Connector

Packing: 1,000 pcs

Art. No.

267.91.163

Order reference

1 piece = 1 set



Processing aids for the Lamello P System Zeta P2 Biscuit jointer



Cutting process

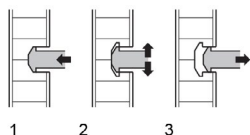

- 1 The cutter cuts into the workpiece until the pre-set depth is reached
- 2 The cutter moves minimally up and down cutting the profile groove
- 3 Removing the cutter

A

- > User Friendly:
 - Triggers the vertical movement automatically
 - Low weight due to the compact design
 - Optical VMD (Vertical Mechanical Drive) control
- > Safe process using reliable, mechanical and low-wear technology
- > Can be used as a standard biscuit jointer as the profile groove function can be switched off

> For installing connectors in profile grooves (Clamex P and Clamex P Medius)

- > Power: 1050 W
- > Version: 230 V
- > Revolution speed: 9000 min⁻¹
- > Cutter: Biscuit jointer blade 100 x 7 x 22mm
- > Teeth: Z3
- > Cutting depth max.: 20mm
- > Weight 3.7kg

Supplied with

- | | |
|---------------------------|--|
| 1 Zeta P2 biscuit jointer | 1 Spacer 4 mm |
| 1 Stop bracket | 1 Set of tools |
| 1 Suction stub 23 mm | 1 Drilling jig with drill bit for Clamex P |
| 1 Suction adapter 36 mm | 18 Pairs of Clamex P connectors |
| 1 Spacer 2 mm | 1 Systainer |

	Art. No.
Lamello Zeta P2 with Diamond Biscuit Jointer Blade	002.18.004 

Packing: 1 pc

T-Groove Diamond Biscuit Jointer Blade 7mm



- > Area of application: For 7 mm profile grooves, for Clamex P connectors and other connectors of the P system, for Lamello Zeta P2 biscuit jointer

	Art. No.
Diamond Biscuit Jointer Blade 7mm	002.18.030 

Packing: 1 pc

CNC Cutter Arbor, Clamex P



- > Material: CNC
- > Length: 85mm
- > Shaft Ø 16mm

	Art. No.
CNC Cutter Arbor, Clamex P	002.18.075 

Packing: 1 pc

CNC Shaft Tool Cutter



- > Material: Solid Carbide
- > Diameter: 12mm x 40mm
- > Length: 80mm

	Art. No.
CNC Shaft Tool Cutter	002.18.029 

Packing: 1 pc

Note:  Indent item

Lamello Cabineo Cabinet Connector

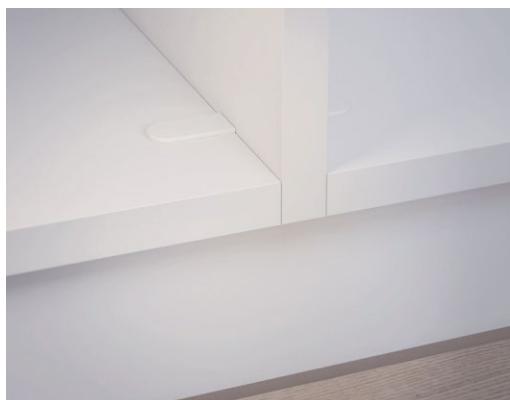
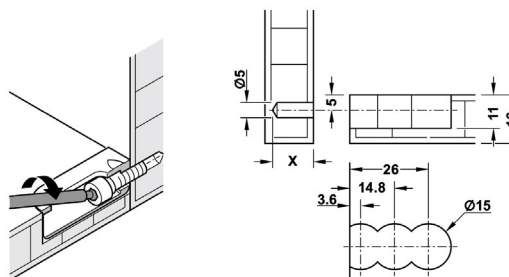

Fig. shows connector with cover cap
Cabineo 8: X = 8 mm
Cabineo 12: X = 12 mm



- > Surface processing only: For use with CNC, edge drillings not required
- > Quick and easy installation provided by pre-mounted connector
- > Additional screws or dowels not required
- > Easy to transport: Flat pack delivery available
- > High clamping force: Solid, positive-fit connection
- > Separable connection
- > For use with or without cover cap



Lamello Cabineo Cabinet Connector

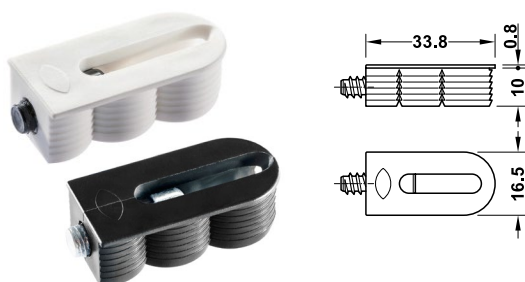

- > Area of application: Connector for corner and centre panel connections, for processing with CNC machines
- > For wood thickness: From 16 (Cabineo 8: From 12)
- > Material: Connector housing: Plastic, glass-fibre reinforced, screw: Steel
- > Colour: White
- > Installation: For press fitting into construction base panel and screw fixing into side panel (drill hole Ø 5 mm)

Version	Dim. X mm	Color	Packing Pieces	Art. No.
Cabineo 12	12	White	500	267.91.252
		Black	1 or 500	267.91.254

Packing: 500 pcs

Cover Cap for Lamello Cabineo 12



Colour	Art. No.
Signal white, RAL 9003	267.91.267 
Black	267.91.262 

Packing: 100 pcs

Mounting Tool for Lamello Cabineo



- > Area of application: For screw fixing the Lamello Cabineo connector

Note

Please note torque of approx. 25 Nm when using the hexagon bit with cordless screwdriver

	Art. No.
SW4 Hexagon bit with ball head, length 120mm	001.26.605 

Packing: 1 pc

Note:  Indent item

2 HINGES AND FLAP FITTINGS

